

ENLARGEMENT A

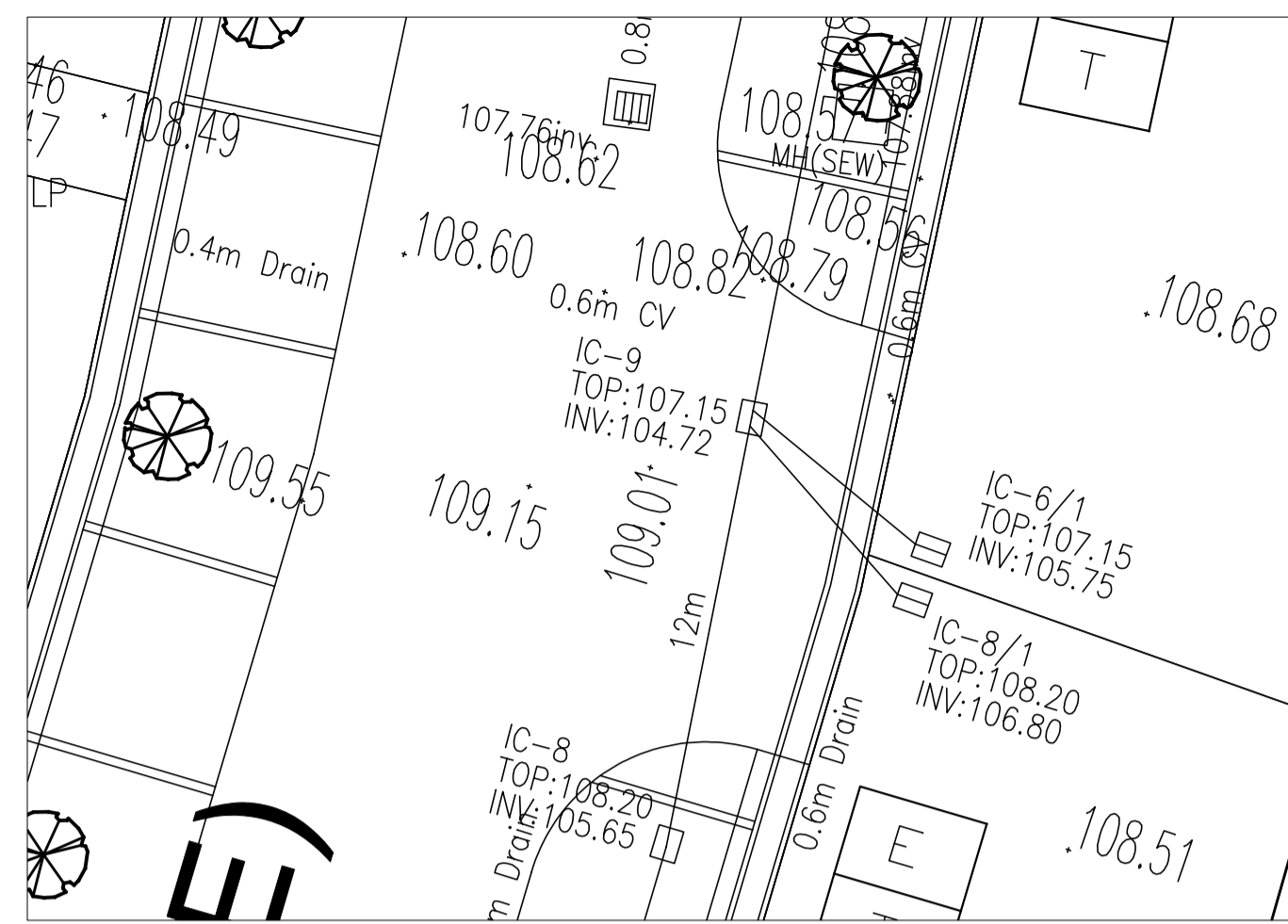

ENLARGEMENT B

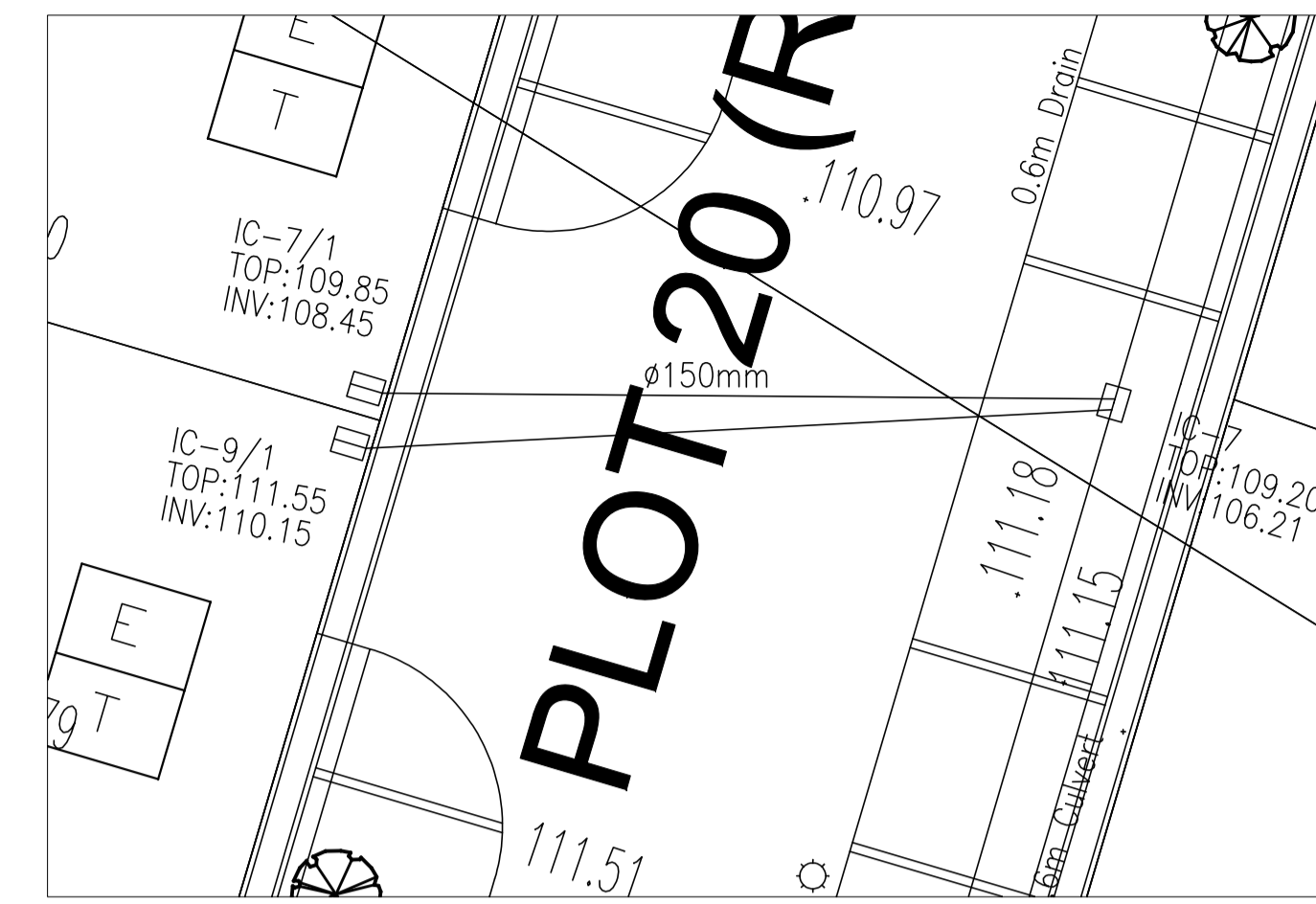

ENLARGEMENT C

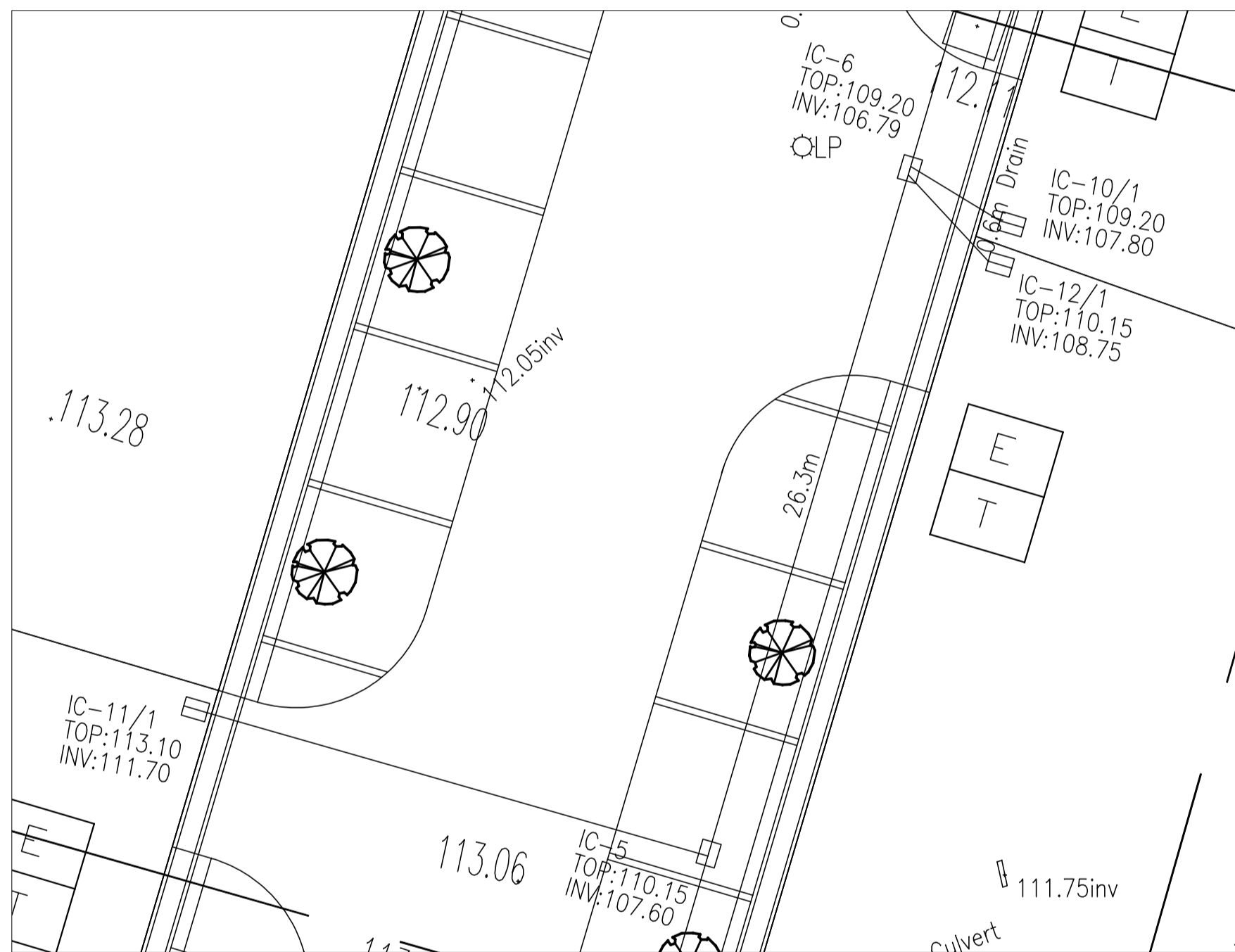

ENLARGEMENT D

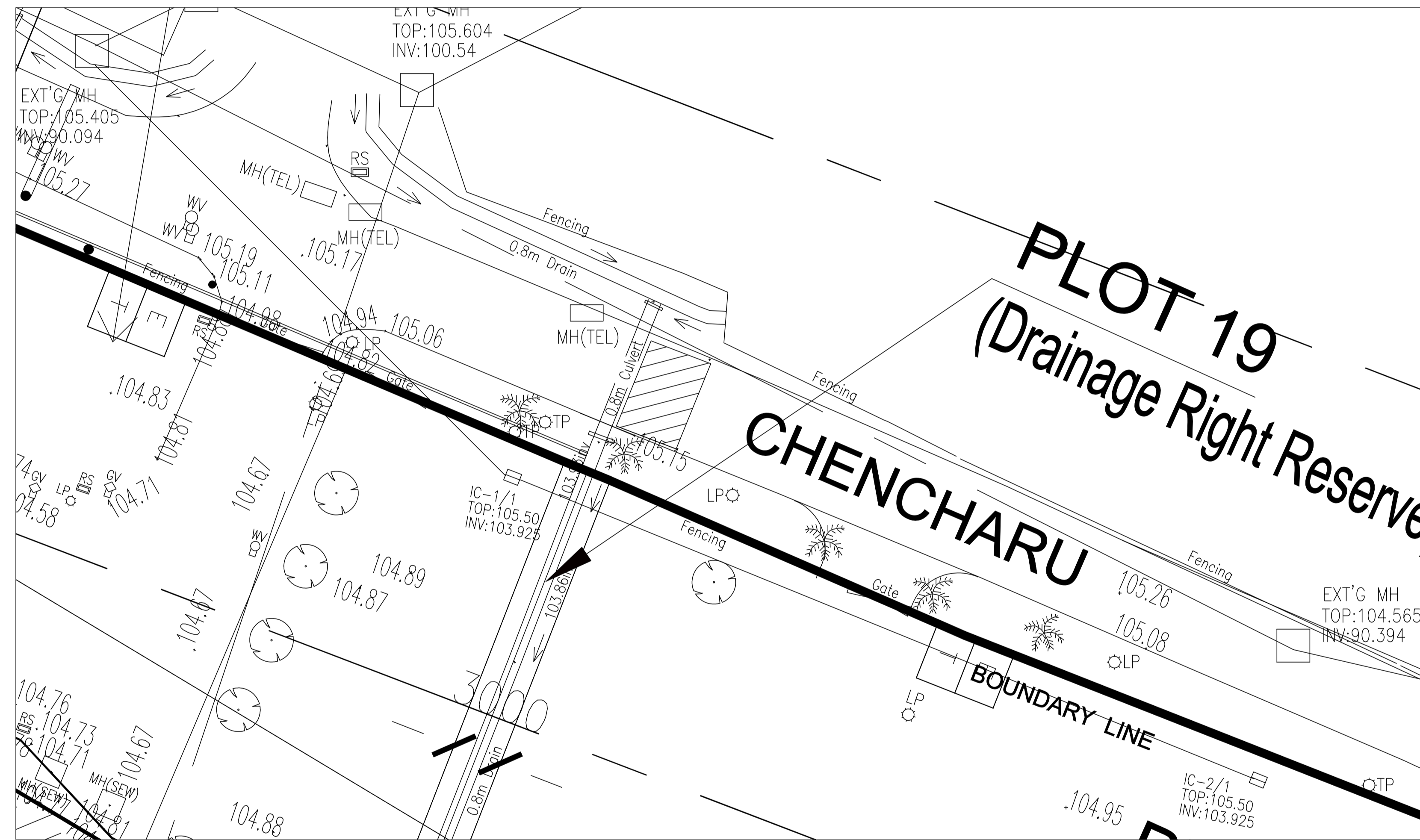

ENLARGEMENT E

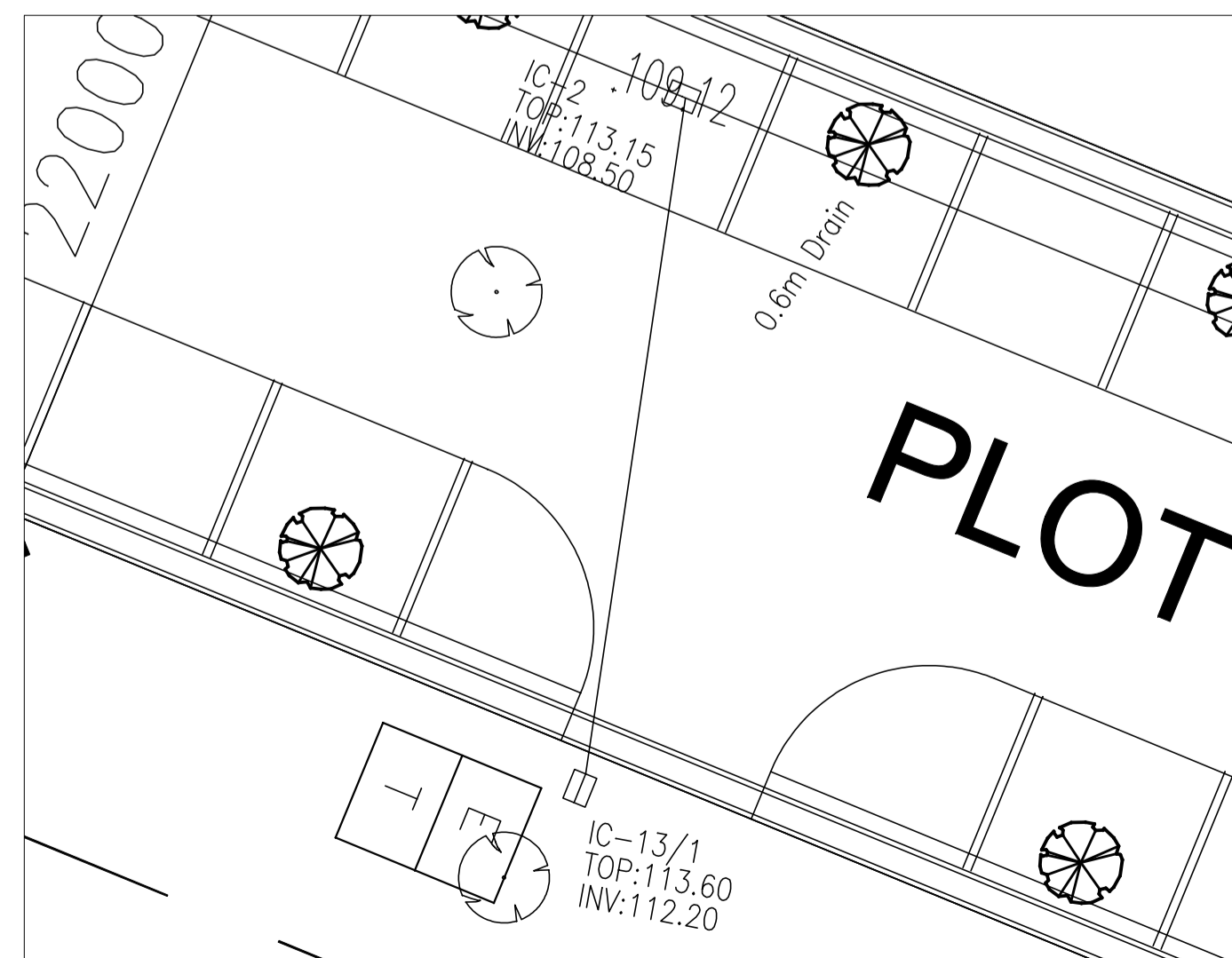

ENLARGEMENT F

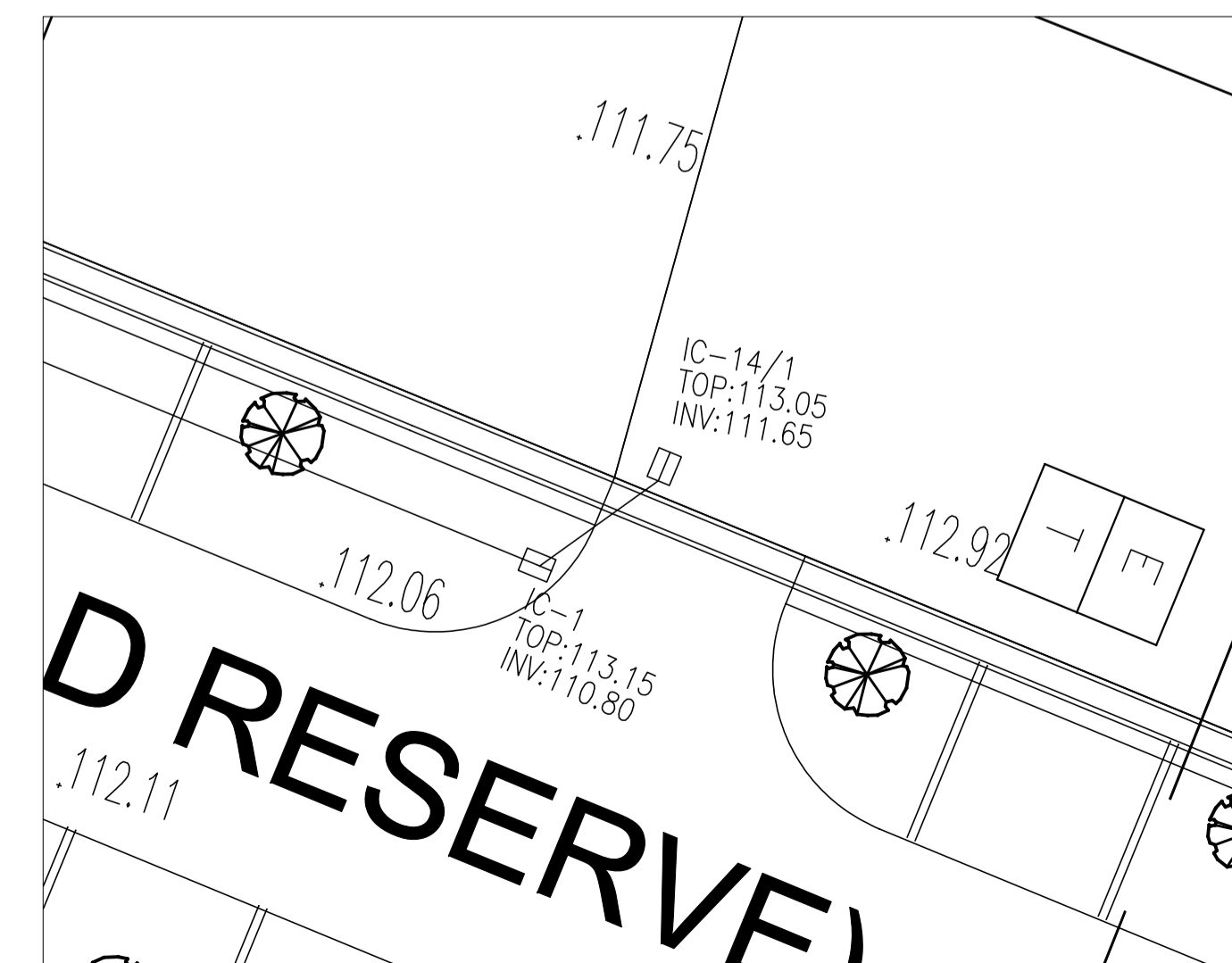

ENLARGEMENT G

REV:	DATE:	BY:	AMENDMENT
OWNER:			
<b>SINGAPORE LAND AUTHORITY</b>			
LAND ASSET MANAGEMENT SERVICE DIVISION ESTATE AND INFRASTRUCTURE TEAM			
55 NEWTON ROAD #12-01 SINGAPORE 307987			
M&E CONSULTANT:			
<b>KJ GROUP CONSULT</b>			
Building Services (Mechanical & Electrical) Consultancy			
NO. 212A TANJONG KATONG ROAD SINGAPORE 437005 TEL: 6345 8909 FAX: 6345 6903 E-mail: kjgroup@singnet.com.sg			
PROJECT TITLE :			
PROPOSED ROAD INFRASTRUCTURE & SERVICES, 15.5M SPAN RC BRIDGE, PUB SUBSTATION AND ANCILLARY WORKS FOR AQUARIUM FISH EXPORT CENTRE AND INTERIM AGRICULTURE USE ON LOTS 2611X(PT), 2613C(PT), 229K(PT), 416W, 1242M(PT), 233N(PT), 232K(PT), 230T(PT) & 231A MK 19 AT LORONG CHENCHARU			
DRAWING TITLE :			
ENLARGEMENT DETAILS			
SERVICE :			
SANITARY DRAINAGE SYSTEM			
DESIGNED BY :	KOH	DRAWN BY :	KOH
CHECKED BY :	KOH	APPROVED BY :	LEE
SCALE :	AS SHOWN	DRAWN DATE :	DEC 2009
DRAWING NO. :	KJ/P/001/SA02		REV NO. :
THIS DRAWING IS COPYRIGHT AND UNAUTHORISED OR MISUSE OF THIS DRAWING IS PROHIBITED WITHOUT THE CONSENT OF <b>KJ GROUP CONSULT.</b>			