

N.33500m  
E.19800m

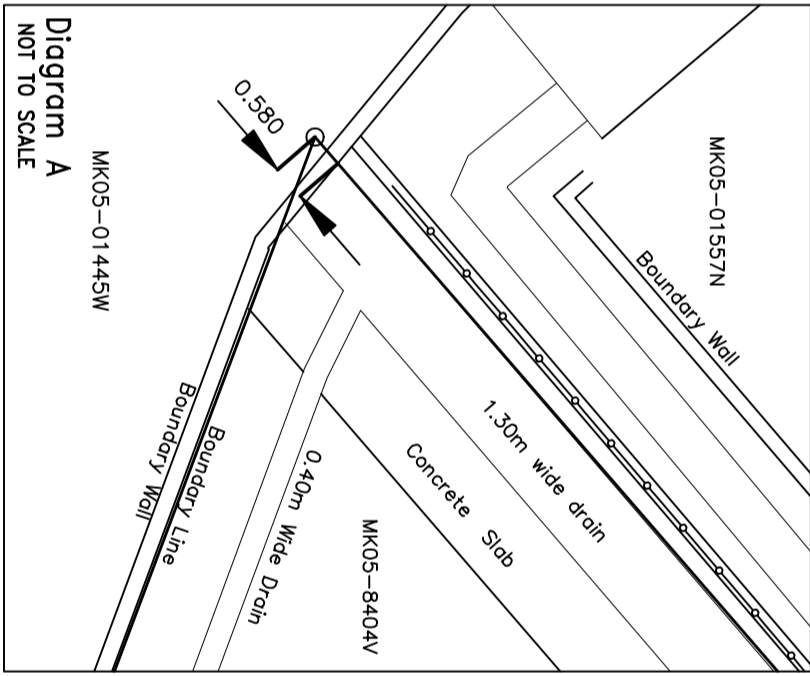

N.33425m  
E.19900m

SITE PLAN:

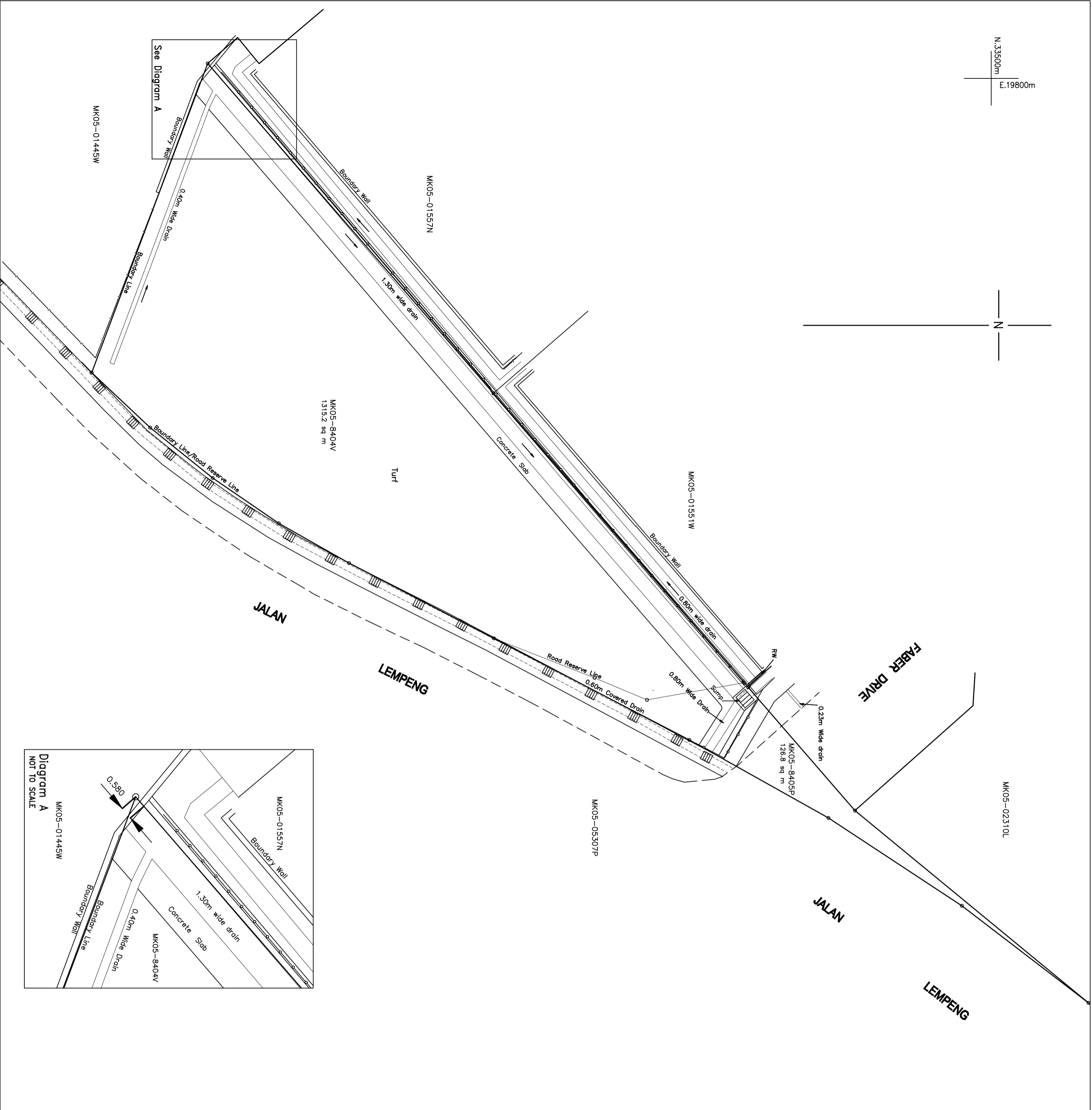
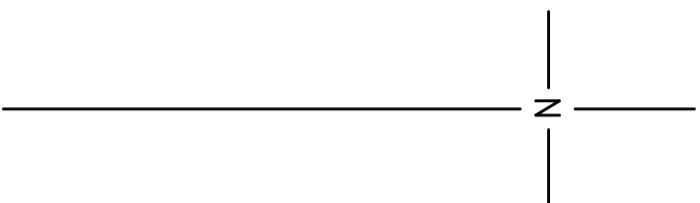
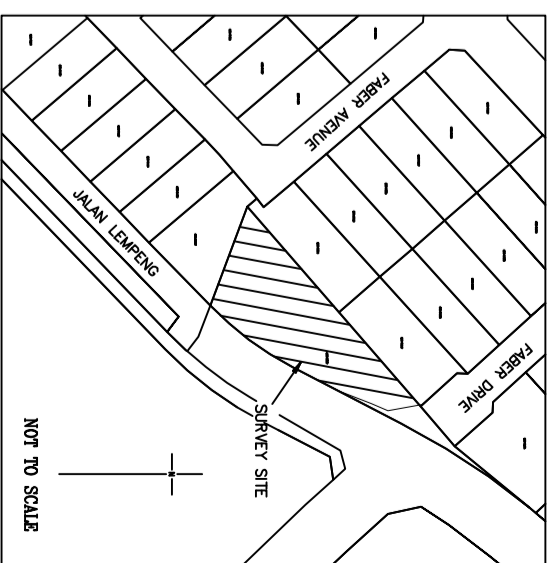

NOTES:

1. ALL LEVELS SHOWN ARE IN METRES.
2. INFORMATION SHOWN HEREON ARE CORRECT AT TIME OF SURVEY.
3. BOUNDARIES SHOWN HEREON ARE PROVISIONAL AND SUBJECT TO ALTERNATION ON FINAL SURVEY.
4. ALL LEVELS ARE SHOWN IN PRECISE LEVELLING DATUM PLUS 100M BASED ON SURVEY DEPARTMENT'S BENCH MARK NO. BM382 (R6.269M) AT CLEMENTI RD/JULU PANDAN ROAD.
5. HORIZONTAL CONTROLS ARE BASED ON SV21 DATUM.

LEGEND :

- IRON GRATING
- FENCE
- RAILING
- RETAINING WALL

PROJECT TITLE:

SPOT LEVEL, SETTING OUT & CADASTRAL SURVEY ON LOT 8404V & 8405P MK05 AT JALAN LEMPENG CONTRACT F

DRAWING TITLE:

ENCROACHMENT SURVEY PLAN

SURVEYOR :

**YJP SURVEYORS PTE LTD**  
10 CENTING ROAD  
#05-00 THE BLUE BUILDING  
SINGAPORE 349473  
TEL: 6743 0938 FAX: 6743 6732  
Email: kimsoo@jpeiny.com.sg



DRAWING NO. :	LS/0508/072/ENC/03
SCALE :	1 : 250
DRAWN BY :	JUNE KIANG
CHECKED BY :	LOH
SURVEYED BY :	TAN
DATE OF SURVEY :	JUNE 2008

**ANDREW YAP CHEE KING**  
Registered Surveyor (Singapore)  
IHO/FIG Category A Hydrographer  
Msc. Hydrography (UK)  
Bsc.(Hons) Surveying and Mapping Sciences (UK)