

SENG & KENG CONSTRUCTION PTE LTD

BLK 721 CLEMENTI WEST STREET 2 #01-122 SINGAPORE 120721

TEL: 65-65635522 FAX: 65-68965655

e-mail: qyl@sengkeng.com.sg

TRIAL PIT TEST

FOR

LAND PARCEL NO. 7

AT

BRADDELL ROAD

Client/Owner : Singapore Land Authority
Conducted by : Seng & Keng Construction Pte Ltd
Inspected & Certified : Millenniums Consultants
Date : 05 June 2008

CONTENTS

	<u>Page</u>
1 INTRODUCTION	1
2 SCOPE OF WORK	2
3 TRIAL PIT LOCATION PLAN	3
4 CABLE DETECTION REPORT	4
5 FINDINGS	6
6 CONCLUSION	8

REPORT:

TRIAL PIT TEST FOR LAND PARCEL NO. 7 AT BRADDELL ROAD

Client : Singapore Land Authority
Location : Braddell Road / Carmichael Road
Land Parcel : 07
Prepared by : Millenniums Consultants (PE)

1 INTRODUCTION

Trial pit excavation was carried out for Land Parcel No. 7 at Braddell Road for the purpose of visual inspection for soil condition and possibility of illegal dumping.

A total of 1 trial pit was excavated for approx. 775.00m² of land at location shown in the Trial Pit Location Plan (as attached). Prior to the excavation, cable detection has been carried out to confirm location of the services as this is a built up area.

The work was carried out according to the instructions given by Singapore Land Authority.

2 SCOPE OF WORK

2.1 The purposes of this Report were:

- a. To explore the sub-surface conditions of the Proposed Development area and to provide general soil data relating to the Project.
- b. To determine the existence of any illegal dumping found on site.
- c. To observe the water table level.

2.2 Description of Trial Pit Excavation

The sequence of works was as follows:

- Site Clearance carried out by excavator.
- Trial Pit locations were determined by pegging on site.
- The trial pits in the size of 1.5m x 1.5m x 3m depth were excavated using hydraulic excavator Kobelco 03 series SK60 and Mini excavator.
- Timber barriers with red and white safety tape were putted up around the pits for safety reason.
- Photographs and visual inspections were carried out by PE.

3 TRIAL PIT LOCATION PLAN

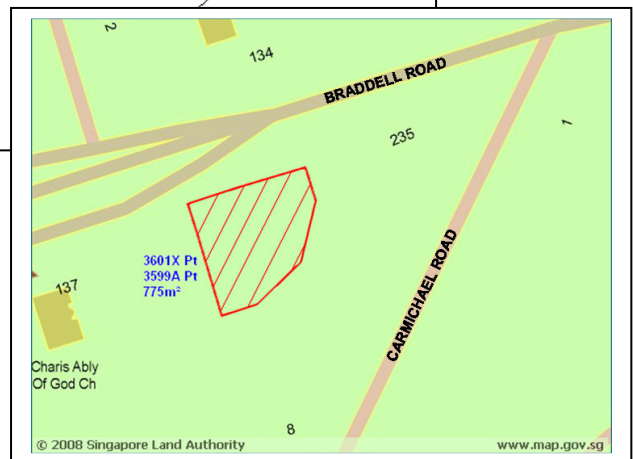
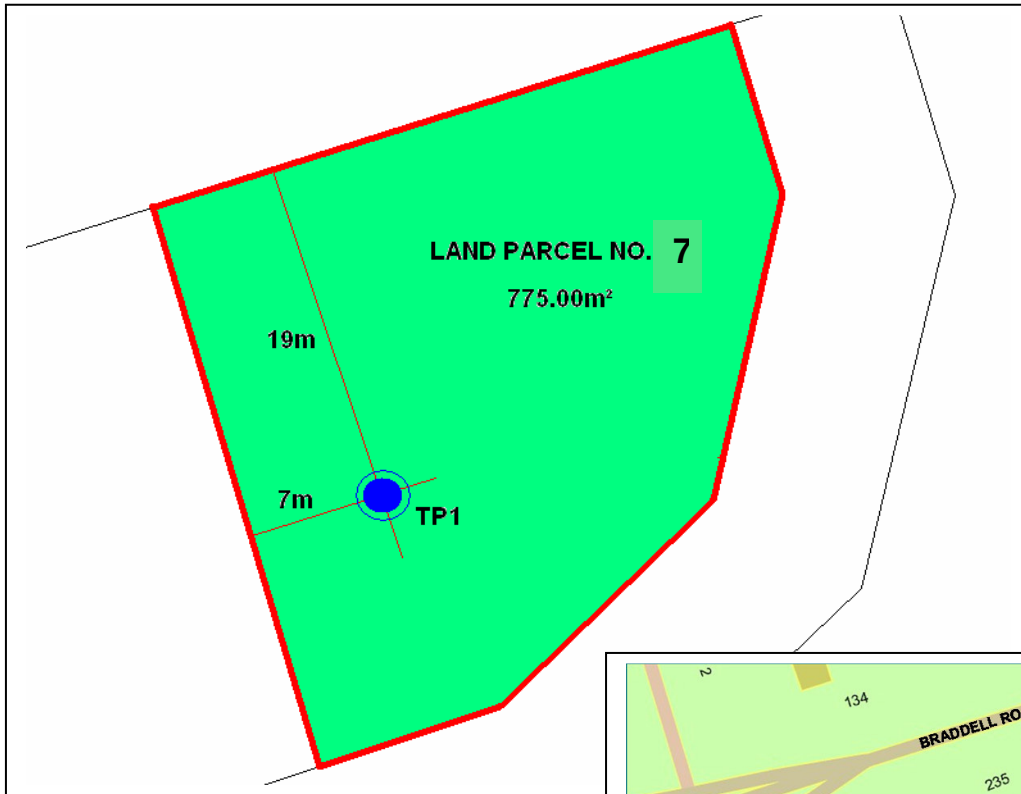

4 CABLE DETECTION REPORT

FORM NCD

Deputy Director
Earthworks Monitoring &
Cable Protection Section
Network Management Division
SP PowerGrid Ltd
25 Pasir Panjang Road
Singapore 117536

(This form is to be submitted with site plans indicating the detection zone clearly before the commencement of cable detection work.)

FAX NO: 64759400
DID NO: 64700604/5

NOTIFICATION OF COMMENCEMENT OF CABLE DETECTION WORK

I, the undersigned, intend to carry out cable detection work. The particulars are as follows:-

- 1 Location of cable detection work: LOT 3599A + 3601 MKJ7 BRADDELL RD
- 2 Particulars of contractor/client: SENG + KENG CONSTRUCTION P.L.
Company / Person-in-charge: QUEK KAI YONG
Address: BLK 721, CLEMENTI WEST ST 2 #01-114
Tel No: 65635522 68965655 Pager No.: 96860016
- 3 Principal: SLA Dept/Section: _____
- 4 Date cable route drawings obtained (LCDW to note mandatory requirement): 3/6/2008
- 5 Date of cable detection to be carried out: 5/6/08
- 6 Voltage Level of the cable in the vicinity? No SPPA's cable / LV/HT's
- 7 Proposed dates for earthworks:
Start: 5/6/08 Finish: 13/6/08
- 8 Purpose of earthworks: SOIL INVESTIGATION WORK

I shall prepare and issue to my client a set of cable detection records and keep EMCP informed of any changes in the above particulars by fax. I will also remind my client to submit the Notice for Commencement of Earthworks (NCE) if there are High Voltage cables within the vicinity.

Signature



SIM YONG KWEE
Name of Licensed Cable Detection Worker

Date: 5/6/08

Licence No. 89-0108

Tel No.: _____

Mobile No.: 98184225

*Delete where applicable.
(Revision Feb 2006)



Braddell Road / Camichael Road lot 3599A x 3601 X MK17.

5 FINDINGS



Location: Land Parcel No. 7 at Braddell Road
Trial Pit No: 001
Size: 1.5m length x 1.5m width x 3m depth
Original State: Land with maintained cow grass turfing

TRACES OF DEBRIS FOUND IN TRIAL PIT



Concrete cube



Rock



Tree trunk



Tree branch

Soil Condition up to 3 metres: The following materials were not found:

- marine clays
- peaty clays
- material from sump
- rubber tyres
- materials susceptible to spontaneous combustion
- organic municipal waste
- other industrial and domestic refuse
- soil of liquid limit exceeding 70 and/or plasticity index exceeding 35
- materials having moisture content greater than the maximum permitted for such materials in the Contract, unless otherwise permitted by the Superintending Officer

Water Table: No sign of high water table

6 CONCLUSION

At the only trial pit that we have inspected, we found some debris within 1 metre depth from ground level. No sign of water table found within the first 3 metres from ground level. The soil condition is good.

Should there be any question regarding our work, we would be pleased to discuss them with you.

The Contents as described in this report for Trial Pit Test for Land Parcel No. 7 at Braddell Road are hereby certified to be correct.



Endorse by Professional Engineer